

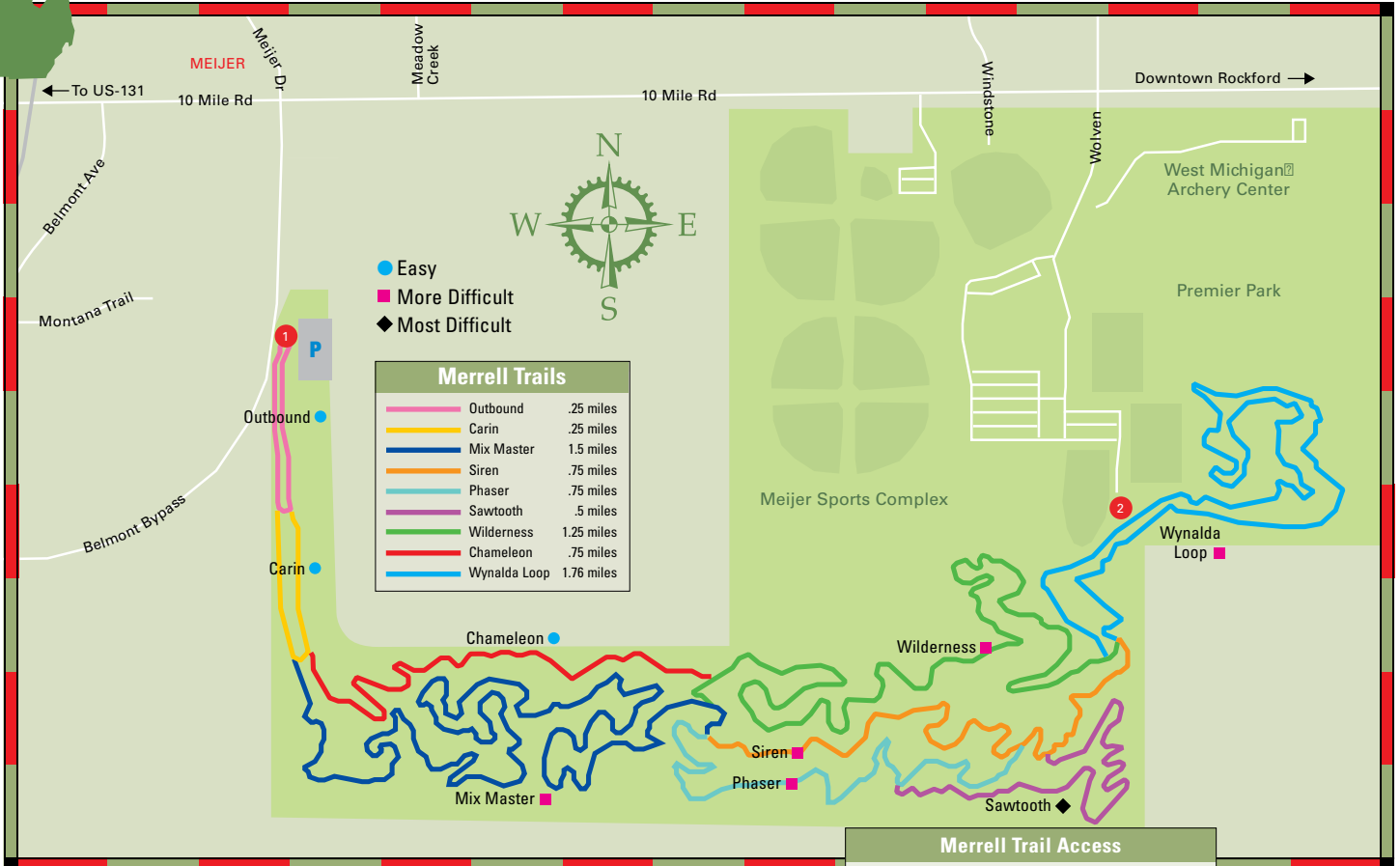

Merrell Mountain Biking Trail



The Merrell Trail

Easy to find, with the trailhead located just east of US-131 on 10-Mile Road (by the water tower) in Rockford, the Merrell Trail is 8.3 miles of pure fun. If you like rollercoasters, you'll love this trail. Many experienced mountain bikers consider it the best "flow" trail in Michigan's lower peninsula and best overall mountain biking trail in the West Michigan area. You've got to ride it and decide for yourself.

One of Michigan's newest mountain biking trails, the Merrell Trail was built with the funding and support of Wolverine World Wide and maintained by volunteers from the West Michigan Mountain Biking Alliance. This unique fast flowing multi-use

trail system is open to cyclists, runners and hikers with a range of trail loops and routes with various skill levels.

All of the trails are one-way, alternating each day of the week. Follow the yellow arrows on Tuesday, Thursday and Saturdays, and the red arrows on Monday, Wednesday, Friday and Sunday. You'll discover fast rolling downhill, challenging climbs, boulder rollovers, berms, bridges and plenty of jumps. Much of the trail is built through old growth forest where you will see magnificent giant beech, oak and maple trees as you travel through deep ravines, lush marshes and huge side slopes. The trail is also accessible from Premier Park.

Merrell Trail Access			
Access Site	Parking	Restrooms	Water
1 Merrell Trailhead	Yes	Portable	No
2 Premier Park	Yes	Portable	No



Many regard the Merrell Trail as one of the best flow trails in Michigan's lower peninsula.

ROCKFORD BIKE SHOP

Family Owned & Operated

ESTD 2020

Sales & Service

169 Marcell Drive Rockford • Michigan

(616) 951-7181

RockfordBikeShop.com

3 See location on map on page 67.